

Ordinance No 24-25 005

LaSalle (Bureau) County
This document prepared by:
Melissa Keegan
Peru Public Library District
1409 11th Street
Peru, Illinois 61354

Mail to: Peru Public Library
District, Attn: Melissa
Keegan, 1409 11th St, Peru, IL
61354

ORDINANCE NO. 24-25 005

An Ordinance Annexing To the Peru Public Library, LaSalle and Bureau Counties, Illinois, Property within the City of Peru, LaSalle County, Illinois, Not Previously In Said Library District or With Tax Supported Library Service

WHEREAS, 75 ILCS 16/15-35 provides that whenever a municipality included entirely or partially within a public library district has annexed or otherwise includes within its boundaries, territory contiguous to the public library district, with no voters residing therein, and without local tax supported public library service, the district may annex such territory by the passage of an ordinance to that effect; and

WHEREAS, the Trustees of the Peru Public Library, Peru, Illinois, a public library district in LaSalle and Bureau Counties, have considered the question of the annexation of the territory described as follows, with initial reference to the respective Parcel Identification Number ("PIN") and corresponding Exhibit identification as attached hereto which set forth more fully the respective parcel legal description and Plat map in respect of that PIN:

1. PIN: 17-18-415-000 Attached map/full legal – Exhibit A

and have determined that said territory is now within the boundaries of City of Peru, a municipality in LaSalle County, and is contiguous to the territory of the Peru Public Library, and has no voters residing therein, and is presently without local tax supported public library service; and

WHEREAS, it is in the best interests of the owners of the territory described as the following attached parcels:

1. PIN: 17-18-415-000 Attached map/full legal – Exhibit A

and the residents, taxpayers and users of the Peru Public Library for the territory to become a part of the Peru Public Library.

NOW THEREFORE, be it ordained by the Board of Trustees of the Peru Public Library, in the Counties of LaSalle and Bureau and State of Illinois, as follows:

Section 1: That the territory described in its entirety as

1. PIN: 17-18-415-000 Attached map/full legal – Exhibit A

is contiguous to the Peru Public Library, has no voters residing therein, and is presently without local tax supported library service. That the territory to be annexed is shown on the plat map attached as part of Exhibit A, which is made a part of this Ordinance.

Although the parcels making up the territory annexed shown on the map exhibit attached do not presently lie within the Peru Public Library, the collected territory does now lie within the boundaries of the City of Peru, and the City of Peru is included partially within the Peru Public Library.

Section 2: That pursuant to 75 ILCS 16/15-35, the Peru Public Library has the power to annex unto it such territory as is included in a municipality which itself is included entirely or partially within a public library district, with no voters residing therein, and which is without local tax supported public library service, and therefore, the territory described above is hereby annexed and incorporated into the Peru Public Library in the Counties of LaSalle and Bureau in the State of Illinois.

Section 3: This ordinance shall take effect and be in full force and effect from and after its passage and approval according to the law, and after filing a certified copy of this Ordinance and the map exhibits attached hereto in the offices of the Recorders of Deeds and the County Clerks of LaSalle and Bureau Counties, Illinois, as provided by law.

Passed by the Board of Trustees of the Peru Public Library and approved by the President thereof this 10th day of October, 2024

APPROVED:

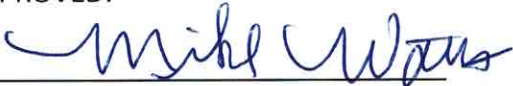

Michael Watts, President

ATTEST:



Larry Sittler, Secretary

STATE OF ILLINOIS)
) SS
COUNTY OF LaSALLE)

CERTIFICATE

I, Larry Sittler, do hereby certify that I am the duly appointed, qualified and now acting Secretary of the Peru Public Library in the Counties of LaSalle and Bureau and State of Illinois; that attached hereto is a true and correct copy of the Ordinance No. 24-25 005 as passed by the Board of Trustees of said Library District at our meeting held on the 10th day of October 2024; and that said Ordinance was duly passed by yea and nay vote thereon with at least a majority of all the Board of Trustees having voted yea on the adoption and passage thereof.

I further certify that said Ordinances have not been amended or repealed but remain in full force and effect at this time.



IN WITNESS WHEREOF, I have signed my name in my official capacity as the Secretary of the Board of Trustees of the Peru Public Library, at Peru, Illinois, 10 October 2024.

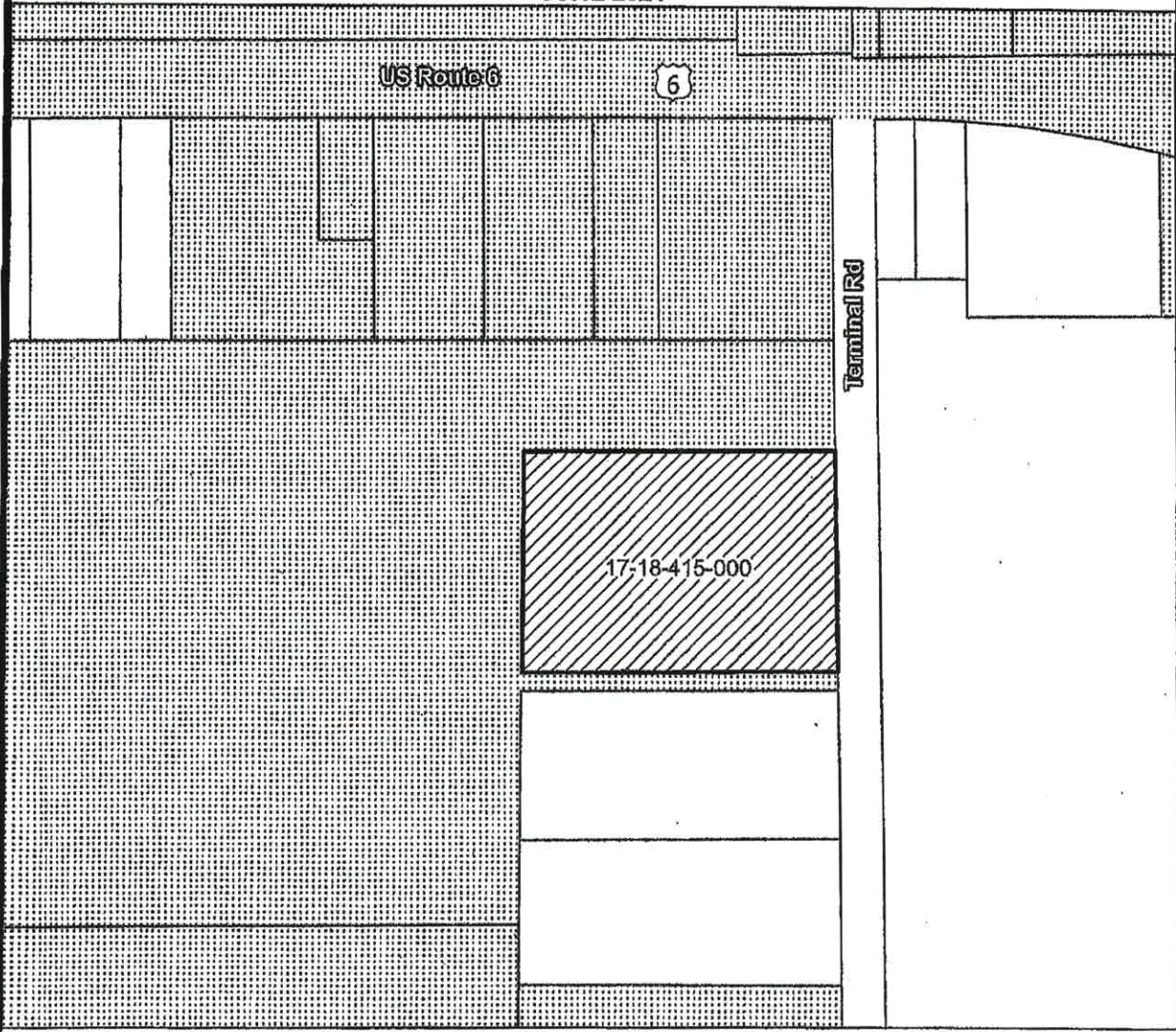
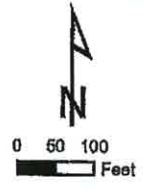

Larry Sittler
Secretary, Peru Public Library

ANNEXATION PLAT
 FOR
PART OF THE WEST 1/2 OF THE SOUTHEAST 1/4
OF SEC. 18, T. 33 N., R. 1 E., 3RD P.M.
PERU, ILLINOIS
JUNE 2024



- Legend**
-  AREA WITHIN EXISTING PERU CORPORATE LIMITS
 -  PROPERTY TO BE ANNEXED (2.8 +/- TOTAL ACRES)



I, MICHAEL S. RICHETTA, HEREBY CERTIFY THAT
 THIS DOCUMENT WAS PREPARED UNDER MY DIRECTION

(Signature)

IL. PLS NO. 035-003788 DATE June 26, 2024



exp/ran 11-30-2024
 PROFESSIONAL DESIGN FIRM
 LICENSE NO. 184-001717
 mlr@chamlin.com

ANNEXATION PLAT

LEGAL DESCRIPTION

Parcel 1:

That part of the West Half of the Southeast Quarter of Section 18, Township 33 North, Range 1 East of the Third Principal Meridian, LaSalle County, Illinois, described as follows:

Commencing at a point on the West line of the Southeast Quarter of said Section 18, which is 40 feet South of the center of the pavement of the highway which is known as United States Route 6, this point is on the South right-of-way line of said Route 6; thence in a Southerly direction, on the West line of said Southeast Quarter from the above described point, a distance of 300 feet to a point marked by a steel stake; thence Easterly and parallel with the South right-of-way line of said Route 6, a distance of 1106 feet to a point; thence South, on a line parallel with the West boundary line of said Southeast Quarter of Section 18, for a distance of 150 feet to the Place of Beginning; thence South on a line parallel with the West boundary line of said Southeast Quarter of Section 18, 300 feet to a point marked by a steel stake; thence West, on a line parallel with the South right-of-way line of said Route 6, a distance of 200 feet to a stake; thence North, on a line parallel with the West boundary line of said Southeast Quarter of said Section 18, 300 feet to a point marked by a stake; thence East, on a line parallel with the South right-of-way line of said Route 6, a distance of 200 feet to the Place of Beginning.

Parcel 2:

That part of the West Half of the Southeast Quarter of Section 18, Township 33 North, Range 1 East of the Third Principal Meridian, LaSalle County, Illinois, described as follows:

Commencing at a point on the West line of the Southeast Quarter of said Section 18, which is 40 feet South of the center of the pavement of the highway which is known as United States Route 6, this point is on the South right-of-way line of said Route 6; thence in a Southerly direction, on the West line of said Southeast Quarter from the above described point, a distance of 300 feet to a point marked by a steel stake; thence Easterly and parallel with the South right of way line of said Route 6, a distance of 1106 feet to a point; thence South, on a line parallel with the West boundary line of said Southeast Quarter of Section 18, for a distance of 150 feet to the Place of Beginning; thence South on a line parallel with the West boundary line of said Southeast Quarter of Section 18, 300 feet to a point marked by a steel stake; thence East, on a line parallel with the South right of way of said Route 6, a distance of 200 feet, more or less, to the West boundary line of the easement for ingress and egress previously granted to Trompeter Construction Company; thence North on the West boundary line of the aforesaid easement previously granted to Trompeter Construction Company, a distance of 300 feet, more or less, to a point; thence West, on a line parallel with the South right of way line of said Route 6, a distance of 200 feet, more or less, to the Place of Beginning.

PIN 17-18-415-000

Page 2 of 2
COCOAL Investments, LLC
Dated 06/21/2024
P8380.00/Y1